



6022-RS1 Deep groove ball bearings

- SKF Explorer

Deep groove ball bearings

Bearing data

[Tolerances](#),

Normal (metric), P6, P5, Normal (inch),

[Radial internal clearance](#),

Matched bearing pairs, Stainless steel
d < 10 mm, Other bearings

Bearing interfaces

[Seat tolerances for standard conditions](#),

[Tolerances and resultant fits](#)

Technical specification

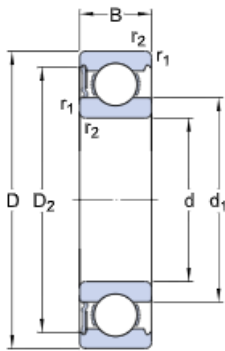

DIMENSIONS

d	110 mm	Bore diameter
D	170 mm	Outside diameter
B	28 mm	Width
d ₁	≈ 129.05 mm	Shoulder diameter
D ₂	≈ 155.3 mm	Recess diameter
r _{1,2}	min. 2 mm	Chamfer dimension

ABUTMENT DIMENSIONS

d _ε min.	119 mm	Diameter of shaft abutment
d _ε max.	128.9 mm	Diameter of shaft abutment
D _ε max.	161 mm	Diameter of housing abutment
r _a max.	2 mm	Radius of shaft or housing fillet

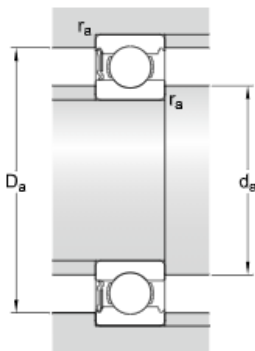

CALCULATION DATA

C	85.2 kN	Basic dynamic load rating
C ₀	73.5 kN	Basic static load rating
P _u	2.6 kN	Fatigue load limit
	2 400 r/min	Limiting speed
k _r	0.025	Minimum load factor
f ₀	15.6	Calculation factor

MASS

	2.02 kg	Mass bearing
--	---------	--------------

TOLERANCE CLASS

P6	Dimensional tolerances
Normal	Radial run-out